

SPACE CLIPPER

Photoetch Set

For Moebius Models kit 2001-2

PGMS
ParaGrafix™
Modeling Systems

INTRODUCTION

Thank you for purchasing ParaGrafix's photoetch set for the Moebius Models Space Clipper. This set may be compatible with the Space Clipper models previously available from Aurora and Airfix, but this has not been tested.

Materials

In addition to the photoetch, you will also need scissors or a knife* to remove individual pieces from the main fret, a file to remove material left from cutting, and super glue (aka CA or cyanoacrylate). Additionally, to fold some pieces, you will need a pair of razor blades** or a specialty tool such as an Etchmate 3C from Mission Models.

* We prefer a #17 Xacto chisel blade.

** Extreme care must be taken when using razor blades. Risk of serious injury.

Lighting

The interior of this photoetch set has many through holes that are suitable for lighting. These include the control panels in the cockpit as well as overhead lighting in the cockpit and passenger cabin. You can use whatever lighting method you prefer (For easy lighting, consider Easy LED from ParaGrafix.)

Installation Parts Order

The installation steps may be taken in any order within the main sections Interior and Exterior. For obvious reasons, all steps in the Interior section must be completed before assembly of the model, while those in the Exterior section are completed afterwards.

Pre-painting

Since the interior pieces will be inaccessible after their assembly you should paint them before assembly. You may find that painting them before removing them from the fret is easier as you can then touch up the attachment points.

Key

Kit part (plastic): ①

Photoetched part: ①

INTERIOR

Cockpit

Fold two copies of the passenger seat (15) as shown and set aside.

Fold two copies of the pilot seat (9) as shown. You can add the two pilot figures (6) to the chairs after folding. Alternatively, you can use the standing figure in the cockpit area.

Fold the cockpit (2) as shown. * = Leave the top flap open until you have installed the seats as shown.

Install the passenger seats (15) in the rear set of slots and the pilot seats (9) in the front set of slots.

Attach the completed assembly to one side of the main fuselage (kit part 5 or 6). Note how the flat plate at the front of the cockpit sits under the kit part and the wall fits within the kit window.

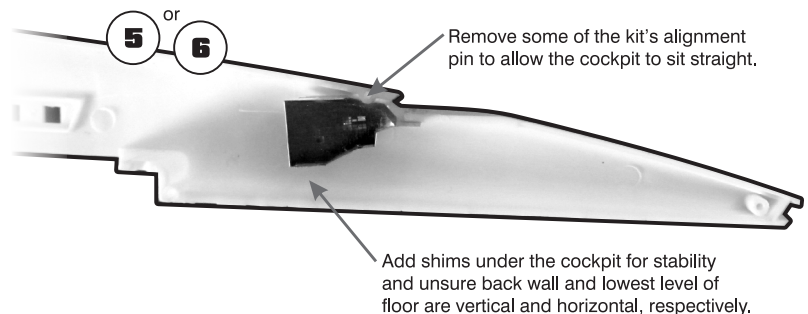
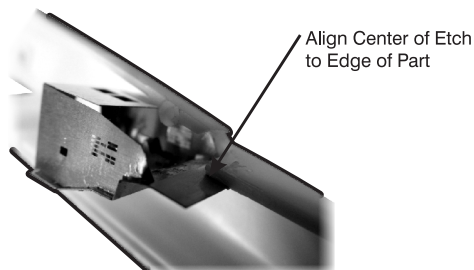
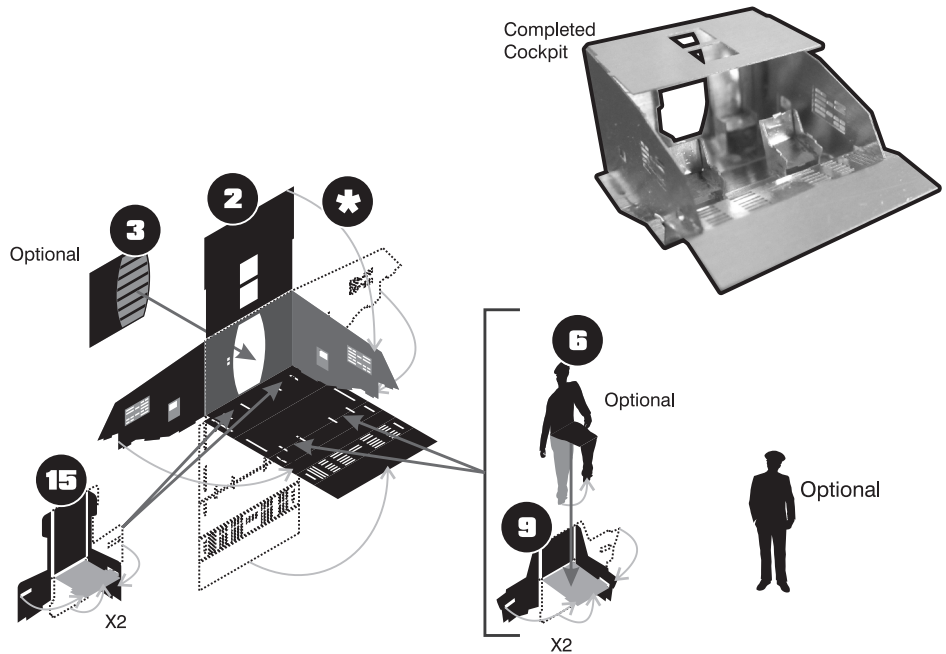

INTERIOR (continued)

Passenger Cabin

Fold 36 passenger seats (15) as shown and set aside.

Fold the floor (14) and ceiling (8) as shown.

IMPORTANT NOTE: The original release of this photoetch set (i.e. those sets that do not include V1.1 or later under "www.ParaGrafix.com" on the etch itself) need to be modified as follows:

A) At the front and back bulkheads, widen the lower opening using a diamond file so that it slides over the raised portion of the floor (14).

B) The tabs do not align properly with the slots on the floor. Remove them.

Install one seat (15) into each of the sets of two slots on the floor (14). If you want to use the Dr. Floyd figure (10), he is placed in the right-hand aisle seat in the 5th row.

Attach the ceiling to the floor, then mount the assembly into one side of the hull so that the seats are centered on the windows. Note that the small arrows on the floor should be aligned with the edge of whichever hull piece you attach it to.

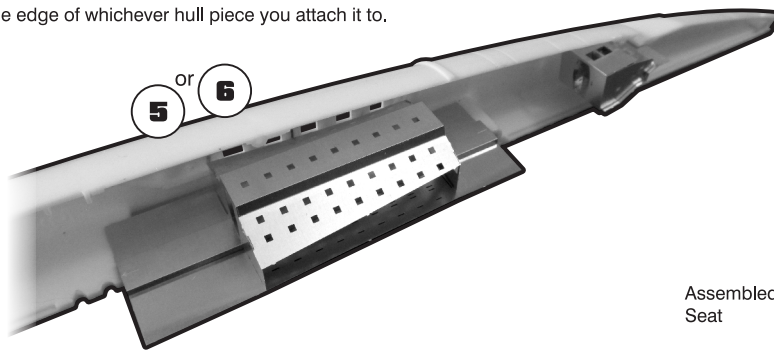
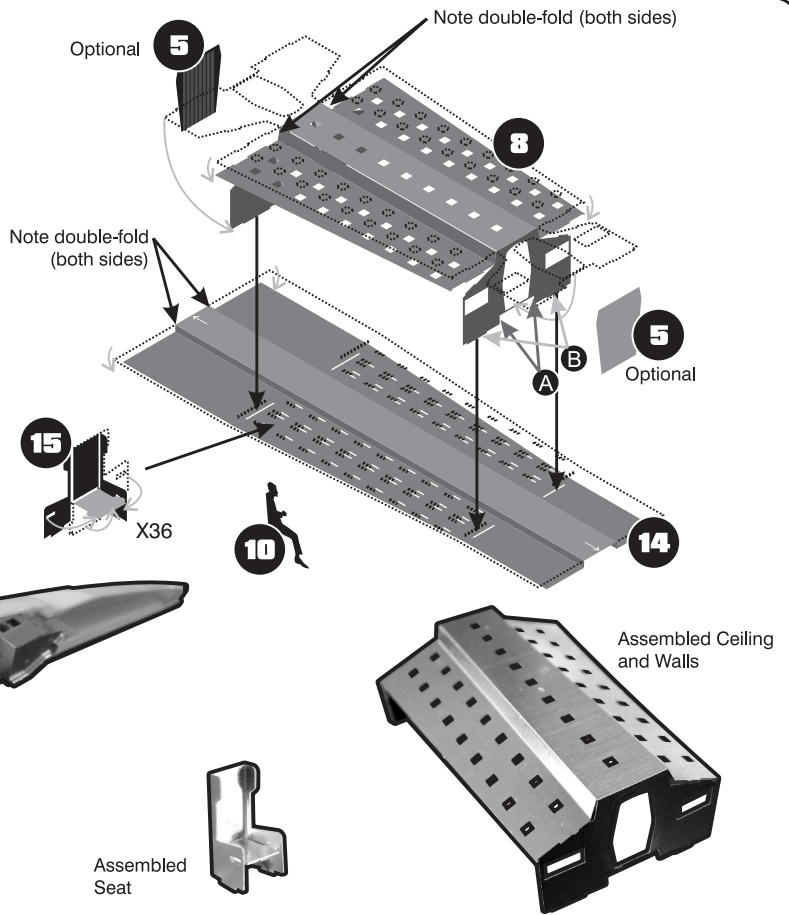

EXTERIOR

Cockpit Window Frames

Form the cockpit window frames (7) over the kit part (15). You can then either mount the kit part and add the etched part over that, or mount the etched part directly to the Space Clipper. (If you mount the etch without the clear plastic piece, place some clear acetate behind the etch, or use Micro

Stand Hole Cover (optional)

Sand off the raised rib detail around the stand cover and replace with etch part 4.

Side Details

Attach Side details 11, 12 and 13 to each side of the fuselage as shown. 11 replaces kit decal 15, 12 replaces kit decal 18, and 13 replaces kit decals 21 and 23.

Logo Ribbing

Since the round logo area of etch part 1 will not bend as readily as the ribbed area, pre-roll the logo area by running it over a 1/2 inch (12mm) or so diameter dowel to give it a curve before trying to mount to the hull.

Über-Detailing: Sand off the raised logo and rear rib before attaching the wings and etch part 1 to get a more accurate profile.

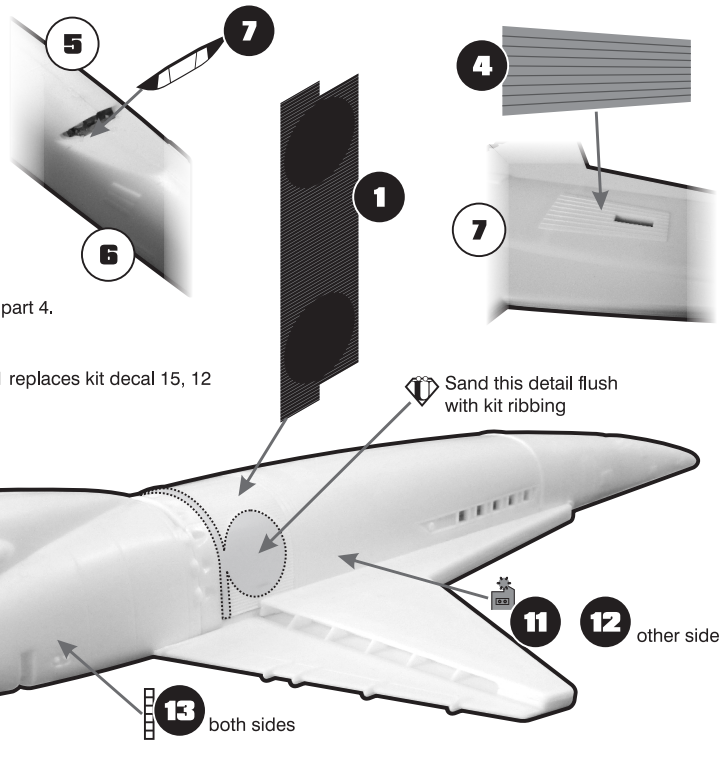

PGMS
ParaGrafix
Modeling Systems

148 Rocklawn Ave.
 Attleboro MA 02703 USA
 +1 508-431-9800
 www.ParaGrafix.biz

Thank you to Frank Winspur and Dave Metzner of Moebius Models for providing us with a pre-release copy of this model.

ParaGrafix™ and PGMS™ are trademarks of Paul H. Bodensiek.
 All Rights Reserved.